

ENGINEERING DATA SHEET

CC04XXP

CONTACTOR
 BUSBAR MOUNTING
 1PST, 400A/28VDC

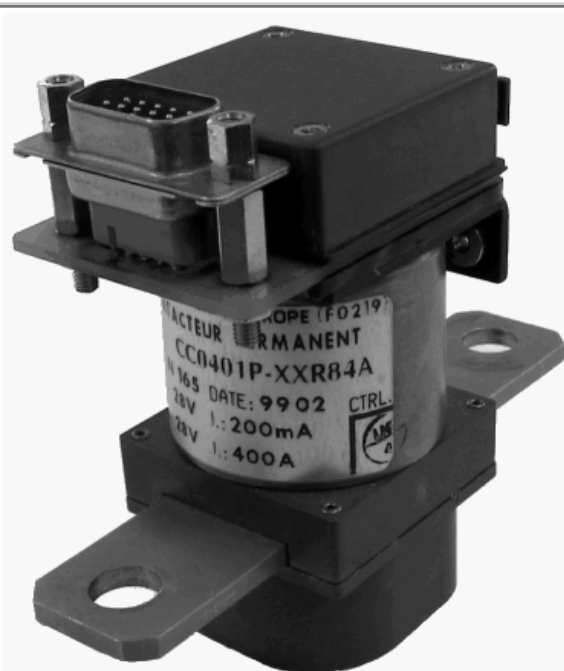

Permanent operation
 Main contact **1PST (DM)**
 Auxiliary contacts **2 or 3 PDT**
 Coil supply **Direct current**
 Related standard **AIR 7304**
AIR 8456B
AIR 9456
MIL 6106J

PRINCIPLE TECHNICAL CHARACTERISTICS

Contacts rating **400 A / 28 Vdc**
 Weight
 - Mounting style A or B and connect 1 or 2 **280 g ±5%**
 - Mounting style C or D and connect 3 or 5 **320 g ±5%**
 Overall size **72.5mm x 41mm x 94.5mm**
 Metal body, thermoplastic covers for dust protection

CONTACT ELECTRICAL CHARACTERISTICS

Contact rating per load type, main contact	Load Current in Amps @28Vdc	
	28Vdc	115Vac/400Hz
Resistive	400	
Inductive [1]	200	
Motor	200	
Intermediate current	40	
Contact rating per load type, auxiliary contact	28Vdc	115Vac/400Hz
Resistive	4	4
Inductive [1]	2	2
Minimum current	2 mA	2 mA

Notes:

[1] L/R 5ms, life 10 000 cycles



Leach International
 www.leachintl.com

North America
 6900 Orangethorpe Ave.
 P.O. Box 5032
 Buena Park, CA 90622 USA

Tel: (01) 714-736-7599
 Fax: (01) 714-670-1145

Europe, SA
 2 Rue Goethe
 57430 Sarralbe
 France

Tel: (33) 3 87 97 98 97
 Fax: (33) 3 87 97 84 04

Asia-Pacific Ltd.
 20/F Shing Hing Commercial Bldg.
 21-27 Wing Kut Street
 Central, Hong Kong

Tel: (852) 2 191 2886
 Fax: (852) 2 389 5803

Data sheets are for initial product selection and comparison. Contact Leach International prior to choosing a component.

COIL CHARACTERISTICS**Series CC04**P**

CODE	R	N
Nominal voltage	28 Vdc	
Maximum voltage	32 Vdc	
Maximum pickup voltage	18 Vdc	
Dropout voltage	1.5 Vdc min. 7 Vdc max.	
Inrush current	6 A max. @ 28 Vcc	
Hold current	200 mA at 28 Vcc	
Suppressor circuit	65 Vpeak	42 Vpeak

GENERAL CHARACTERISTICS

Temperature range	-55°C to +85°C	
Life at nominal load	50,000 cycles	
Dielectric strength at sea level	1250 Vrms	
Dielectric strength at altitude 25,000 m	500 Vrms	
Insulation resistance at 500 Vdc	100 M Ω	
Sinusoidal vibrations	10G / 5 to 2000 Hz	
Shock	30G / 11 ms	
Maximum contact opening time under vibration and shock	10 μs	
Maximum operate time at 28 Vdc	30 ms	
Maximum dropout time at 28 Vdc	20 ms max	
Power contact voltage drop - initial value - After life	120 mV 180 mV	
Auxiliary contacts - Voltage drop at 1 Amp - Contact resistance at low level (<20 mA) - Minimum current	70 mV max 1Ω 2 mA	
Mounting torque		
- Power terminal	M8 M5	9 Nm 2.45 Nm

CONFIGURATION STYLES

MOUNTING STYLES

ACCORDING TO CONNECTION MODE

ACCORDING TO MOUNTING STYLE

MOUNTING DIMENSIONS		
	A	B
TYPE 1	40	31
TYPE 2	35	43
TYPE 3	33.5	30
TYPE 4	30	48
TYPE 5	40	38

NOTE : 1 & 2 = STANDARD TYPES
OTHER CONFIGURATIONS ON REQUEST

DIA

STYLE A - 8.5 DIA HOLE
STYLE B - 5 DIA HOLE

THREADING

STYLE C - M5 CAPTIVE SCREWS
STYLE D - UNF 10/32 CAPTIVE SCREWS
MOUNTING STYLE A AND B WITH MOUNTING DIMENSIONS 2, 3 AND 5 ARE COMPATIBLE WITH CURRENT SENSORS (SEE BOOK 3).

COIL AND AUXILIARY CONTACTS CONNECTOR TYPE

	TYPE CONNECTOR SUB-D	DIMENSIONS	
		A	B
TYPE 3	9 PTS/2 LINES	35.5	13.9
TYPE 4	15 PTS/3 LINES	35.5	18.35
TYPE 5	15 PTS/2 LINES	40	13.9

CONNECTOR PIN LOCK

CONNECTOR

JUNCTION BY CONNECTOR 65239-005 (BERG)

JUNCTION BY CONNECTOR 66987-05 (BERG)

CABLE SIDE VIEW

LOCATING KEYS

JUNCTION BY CONNECTOR SIB-D

TYPE 1

TYPE 2

TYPES 3 - 4 - 5

STANDARD TOLERANCE: .XX ± .76mm

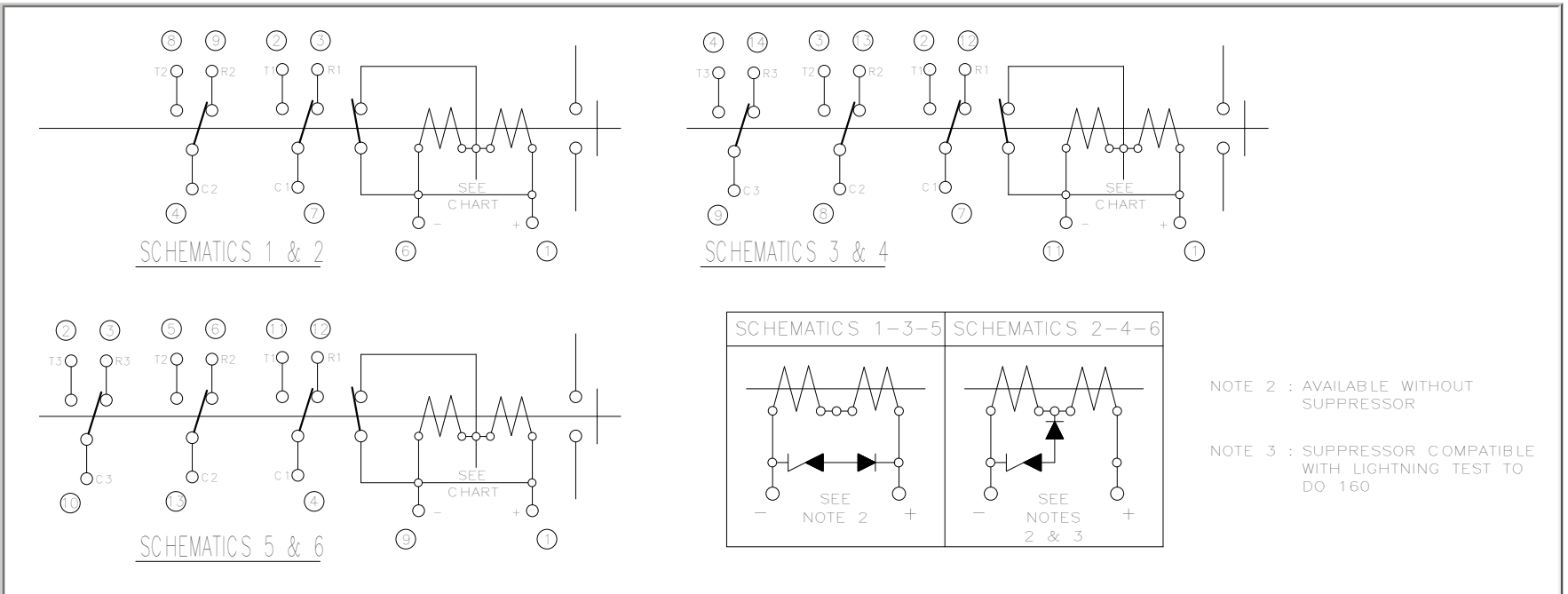

NOTE 2 : AVAILABLE WITHOUT SUPPRESSOR

NOTE 3 : SUPPRESSOR COMPATIBLE WITH LIGHTNING TEST TO DO 160

NUMBERING SYSTEM

P/N	MOUNTING STYLE	MOUNTING SIZE	SCHEMATIC	CONNECTOR CODE	CONNECTOR TYPE
CC0438P-XXN78A	C	1	1	3	SubD 9 contacts M 24 308/24-1F
CC0401P-XXR84A	A	2	4	4	SubD 15 contacts Mil-C-24308C
CC0438P-XXN86A	C	1	5	5	SubD 15 contacts M 24 308/24-2F
CC0401P-XXR01B	A	5	6	5	SubD 15 contacts M 24 308/24-2F

MOUNTING ACCESSORIES

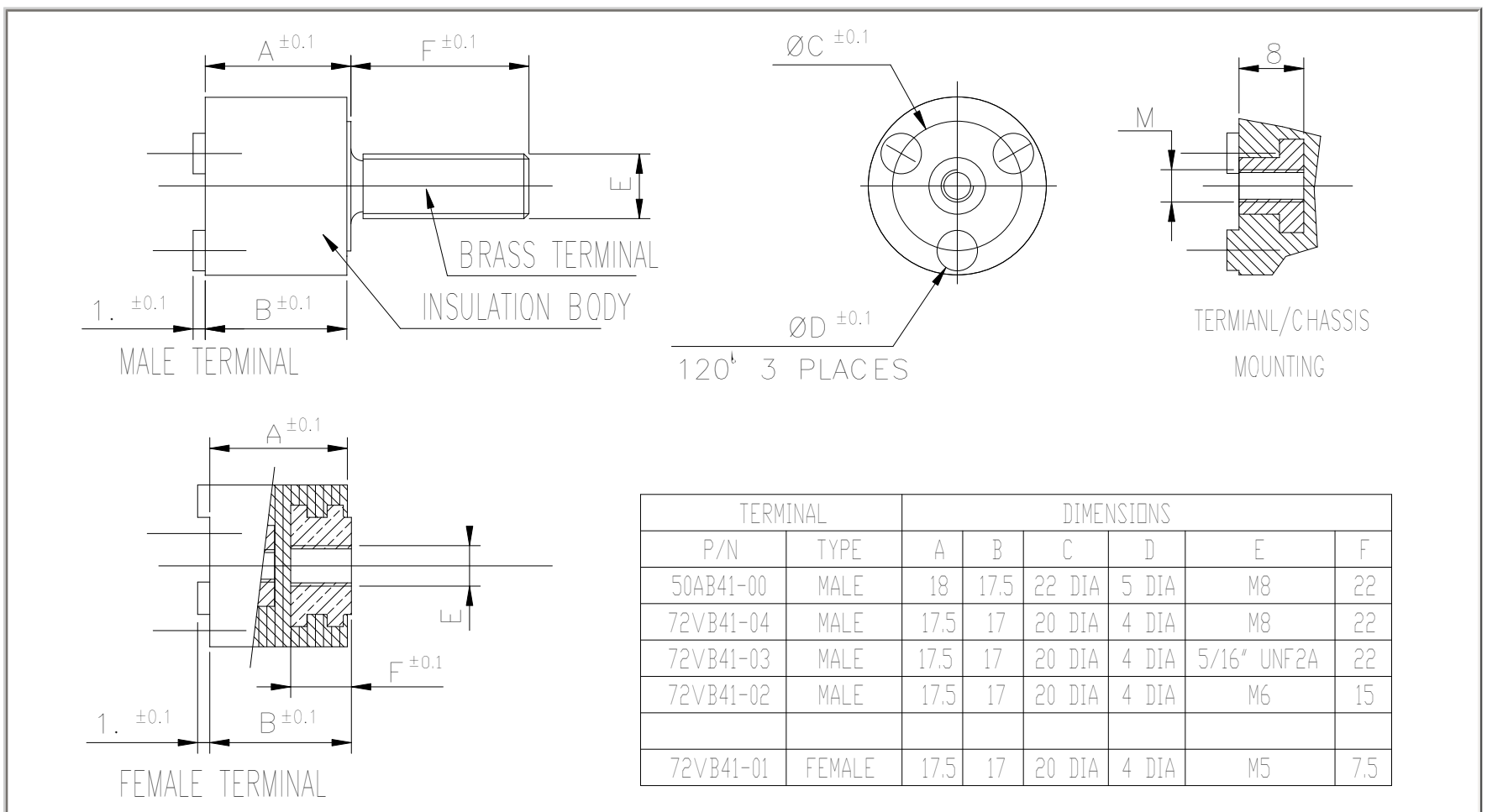

STANDARD TOLERANCE: .X ± .5mm